

Silicone Finger Test Probes

Test Method Reference: ASTM F1578 and F1597

OVERVIEW

These finger probes can be used as a repeatable probe for cycle testing switches, buttons and membrane switches and touch screens. The silicone finger probe design meets the specifications as set forth in the ASTM F1578 and ASTM 1597 (figure 1 or figure 2). The conductive option works great for capacitive touch screens.

Life cycle testing requires a repeatable method and device for consistent testing and these probes should be part of the device. These can be used on Norman Tool button and contact testers as well as adaptable for other brands of testers.

FEATURES

- Consistent Durometer
- Durable for Life Cycle Testing
- Available in various threaded mounting sizes
- Conductive Option is available

SPECIFICATIONS

- **Dimensions:** Within ASTM specifications F1578 & F1597
- **Durometer:** Shore A 45 +/- 5 (50 +/-5 for conductive probes)

ORDER INFORMATION

- **FP1-0832** #8-32 Male Thread (ASTM Fig1)
- **FP1-1032** #10-32 Male Thread (ASTM Fig1)
- **FP2-0540** #5-40 Female Thread (ASTM Fig 2)
- **FP2-0832** #8-32 Female Thread (ASTM Fig 2)
- **FP2-1032** #10-32 Female Thread (ASTM Fig 2)
- **FP1C-0832** #8-32 Male Thread Conductive Black (ASTM Fig 1)
- **FP1C-1032** #10-32 Male Thread Conductive Black (ASTM Fig1)
- **FP2C-0832** #8-32 Female Thread Conductive Black (ASTM Fig2)
- **FP2C-1032** #10-32 Female Thread Conductive Black (ASTM Fig2)
- **FPA-M408** Thread adaptor M4x0.7 male x #8-32 female
- **FPA-M508** Thread adaptor M5x0.8 male x #8-32 female



NORMAN TOOL
TEST EQUIPMENT & SUPPLIES

A Global Leader Since 1964

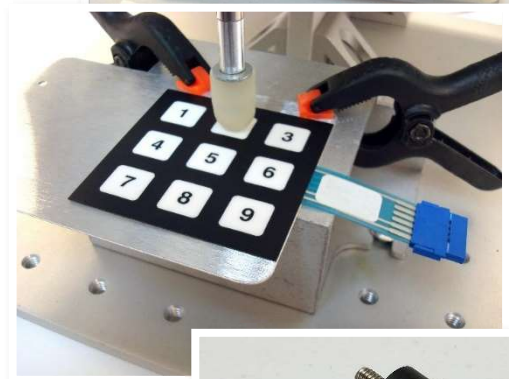

Pledge for Quality

Look for our new seal for your Certified Norman Tool equipment purchases. Guaranteed quality, made in the USA.

Finger Probe Dimensions

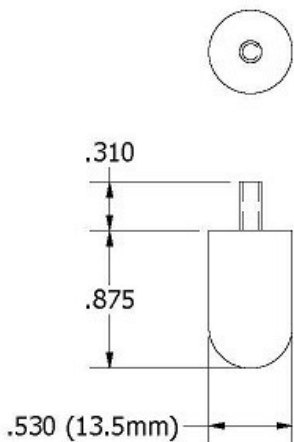

FP1

SILICONE
 45+/-5 DUROMETER (SHORE A) WHITE
 50+/-5 DUROMETER FOR CONDUCTIVE PROBES, BLACK
 AS TESTED BY ASTM METHOD D2240

ASTM DIAMTER SPECIFICATION RANGE
 .5 in (12.7 mm) to .875 in (22.2 mm)

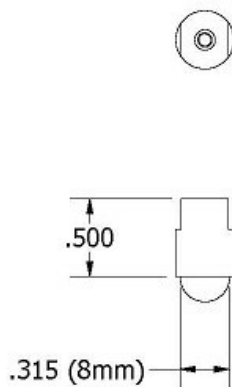

FP2

SILICONE
 45+/-5 DUROMETER (SHORE A) WHITE
 50+/-5 DUROMETER FOR CONDUCTIVE PROBES, BLACK
 AS TESTED BY ASTM METHOD D2240

ASTM DIAMTER SPECIFICATION RANGE
 .31 in (8 mm) to .39 in (10 mm)

Adaptor Dimensions

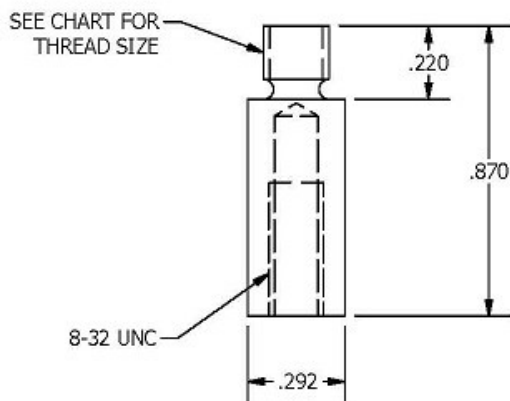

| Finger Probe Mounting Adaptors | | |
|--------------------------------|------------------|--|
| Part # | Male Thread Size | Description |
| FPA-M408 | M4 x 0.7 | M4 male x #8-32 female (for 35N actuator) |
| FPA-M508 | M5 x 0.8 | M5 male x #8-32 female (for 9.2N actuator) |